



Photo for illustrative purposes only

## TURNKEY READY

H&L From: **\$575,000**

Lot 1/36 Elphicks Way Land Size: 337m2



### Turnkey Package Inclusions

- Fixed Site Costs
- 2550mm High Ceilings
- Reverse Cycle Heating and Cooling
- Feature Entrance Door with Trilock
- Flooring Throughout
- Stone Benchtops to Kitchen
- Stainless Steel Kitchen Appliances
- Cold Water to Fridge Space
- Niches in Bathrooms
- Blinds and Flyscreens
- LED Lighting Package Including Ceiling Fans
- Paths, Driveway and Crossover
- Landscaped and Fully Fenced Including Gates
- Feature Façade Lights
- TV Antenna, Letterbox, Clothesline

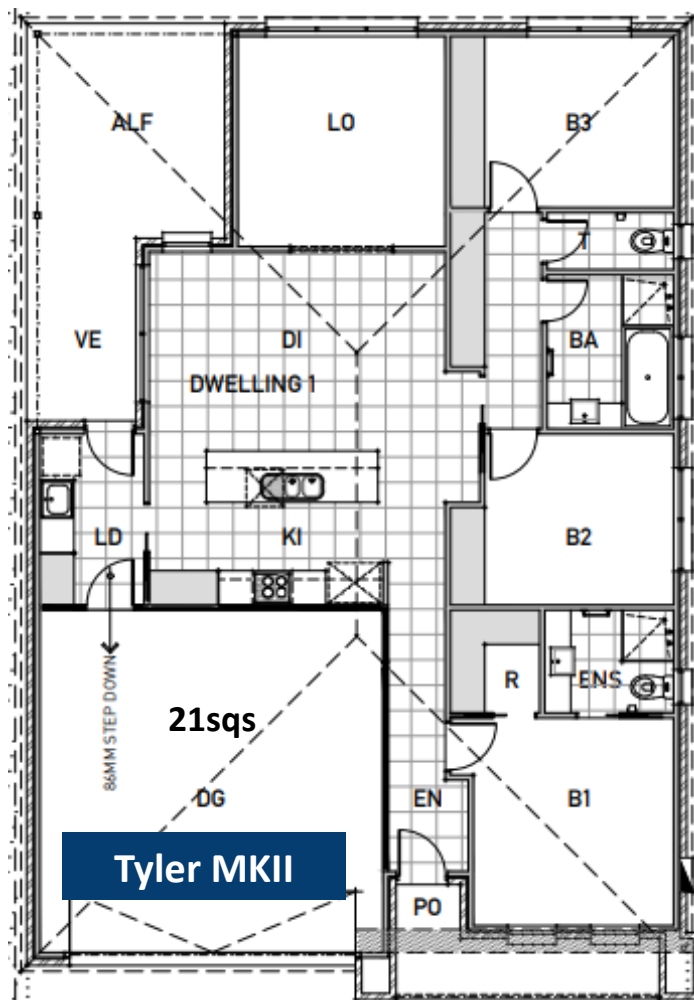

\*Prices may change without notice.